

A) Before replacing the bulb, make sure that its specifications (voltage in V, power in W) are compatible with the technical specifications of the lamp.



B) <REPLACING BULBS>
If bulb has failed, unplug the lamp.
1) Check the Bulb.



C) Do not touch the bulb with your bare fingers. If you touch the bulb, it must be cleaned with a soft, clean cloth.



D) During operation, the bulb may reach temperatures exceeding 350°C. Therefore, do not touch the bulb during operation and let it cool down completely before attempting to replace it.



E) Keep the lamp away from moisture during operation.



F) Use only low pressure halogen bulbs.

DRINK W1

Technical specifications: operating voltage 120V ac 50Hz

LIGHT SOURCE S1

POWER	MAX 60W
VOLTAGE	120V
SOCKET	G9
LAMP TYPE	T4

Attention: Installation must be carried out by qualified personnel.
Follow the installation phases described on the instruction sheet carefully.

Switch off the general power supply until the installation of the lighting equipment has been completed.

1

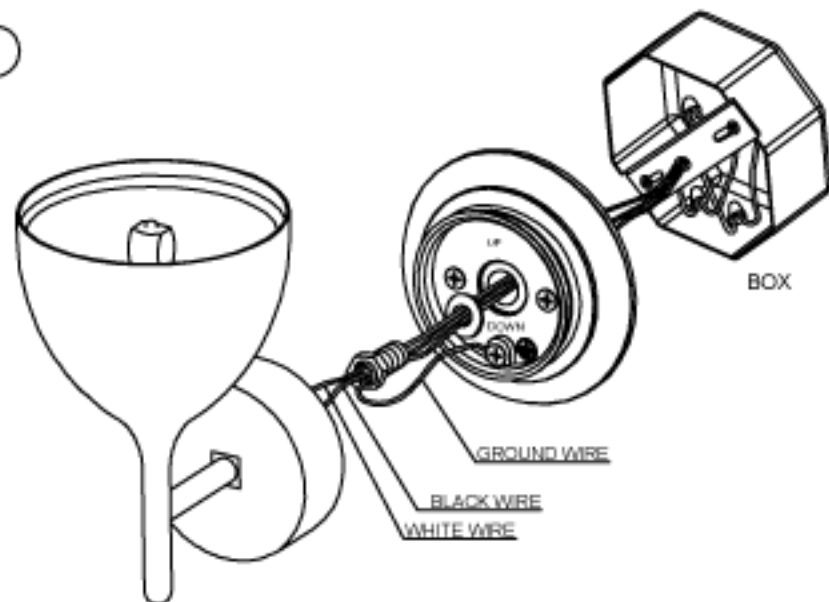

2

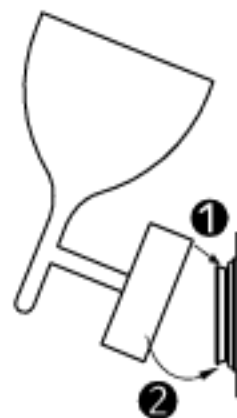

3

